

Eventhall

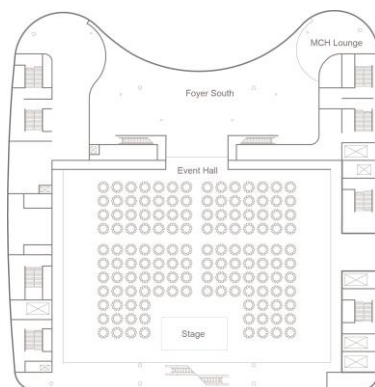

Gross exhibition area



Floor plan



Height



Floor load

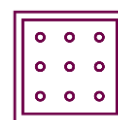

Pillar grid



Load capacity suspension points

	Gross exhibition area	Floor plan	Height	Floor load	Pillar grid	Load capacity suspension points
Foyer	1'000 m ²	-	-	1'400 kg/m ²	Pillar-free	500 kg
Hall	3'300 m ² 2'600 m ² with partition	65 × 50 m	9.5 m	1'400 kg/m ²	Pillar-free	500 kg
Gallery	906 m ²	-	-	500 kg/m ²	Pillar-free	-

Information

- multifunctional, pillar-free hall on the ground floor of the Herzog & de Meuron hall complex
- accessible from the South Foyer or via a raised walkway from the Congress Center Basel
- direct access to the South Gallery and MCH Lounge
- partition walls reduce the hall size from 3,300 m² to 2,600 m², improving the acoustics still further
- daylight possible through the glazed rear wall
- Fully air-conditioned
- flexibly installable stage
- basic AV systems that can be extended in increments
- pre-rig designed especially for the hall, also suitable for elaborate event installations
- unique inscription system with a 112 m-long LED light band in the foyer
- Minergie Standard Label BS-054

Built	2013
Architect	Herzog & de Meuron
Storeys	EG, Foyer with gallery
Overall area	4'500 m ² (useable area)
Floor covering	Cast asphalt
Media points	1 media point per 67 m ²
Communication technology	Glass-fibre network, internet, telephone system, P-WLAN
Toilets	
Ladie's toilet	8
Men's toilets	5
Urinals	11
Disabled toilets	1
Lifts	
Goods and person lifts	9
Dimensions	4.0-4.75 x 1.9-2.65 x 2.19-3.16 m
Permitted load	2'000-5'000 kg
Gate size	6.0 m wide, 4.5 m high